

# SAFEMARK™

## Dependable Security



### Optional High Security Key Override System

Hotels depend on reliable, emergency access to their safes and Safemark's industry-leading override systems deliver confidence. Safemark will undoubtedly meet your security needs while maintaining the design integrity of your guest room.

#### Optional High Security Key Override System

Concealed behind a plate, the cylinders are customized to each property with a unique pinning code. Unlike skeleton keys, the high security keys cannot be easily copied and additional keys are only available from the manufacturer with proper authority. The lock is virtually pick proof and cannot be bumped.



**High Security Key Override**



#### LS7 Cylinder from MIWA

High security cam lock with special key change mechanism has superior operational performance and anti-picking due to sidebar technology. A cost effective approach, keys can be reprogrammed over and over again, without the need to replace the body.

#### Patented LS7 Features

- Superior operational performance and anti-picking due to the use of sidebar technology
- Key codes can be changed on the fly with a simple turn of the old and then the new change keys
- Easy operation of keys with almost no binding on insertion and removal, thus reducing key wear and extending product life
- Both Keys and Locks can be serial stamped for simple tracking and auditing
- When changing the key code on the lock, the tail and cam remain in the locked position, thus maintaining security and improving efficiency
- Locks are shipped with an "off-floor" code for lockable functionality during set-up or EGM factory installation and ready for immediate code change

## Mechanical Specifications

### Cylinder

- Disk tumbler method with side bar  
(7 lines tumbler, 4 different increment)
- Approximately 10,000 practical key combinations
- Turning direction (R or L) can be changed in the field

### Key

- Patented key ward prevents unauthorized key duplication
- User friendly reversible key for easy insertion
- Keys are made of nickel-silver for increased durability

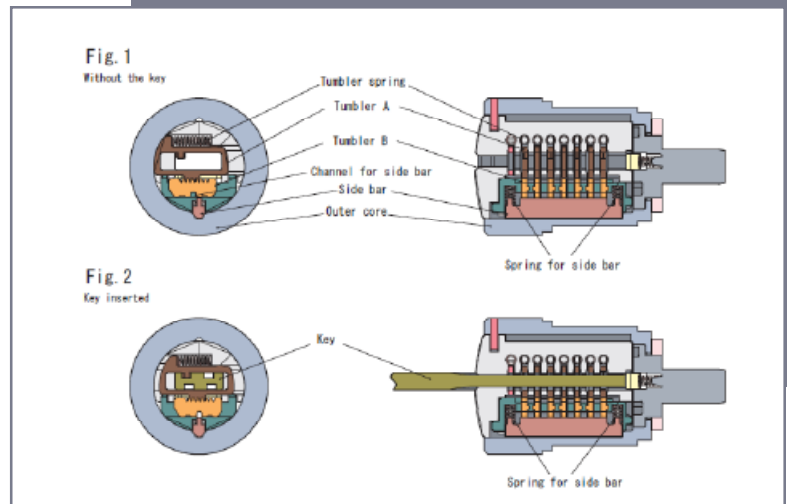

## Easy 4 Step Key Change Process

1. Insert the appropriate change key then turn 180° clockwise
2. Pull the change key at neutral position
3. Insert new operation key, then turn 180° clockwise
4. Pull the new operation key then complete key change

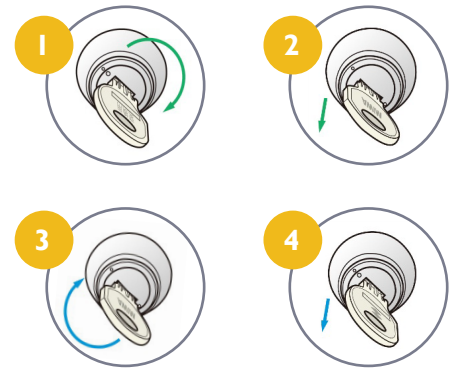

SAFE AUDIT REPORT	
Guest Operation Example Hotel	
Room No. : 205	Printing Time: 05-05-2015 22:09:54
TIME	OPERATION METHOD
05-05-2015 14:56:30	OPENED BY GUEST CODE
05-05-2015 14:56:41	LOCKED BY GUEST CODE
04-30-2015 14:55:52	OPENED BY GUEST CODE
04-29-2015 14:57:11	LOCKED BY GUEST CODE
04-28-2015 14:58:34	OPENED BY GUEST CODE
04-23-2015 14:59:47	OPENED BY GUEST CODE
04-17-2015 15:00:00	
04-12-2015 15:00:00	
04-11-2015 15:00:02	
04-09-2015 15:00:04	
04-06-2015 15:01:00	
04-06-2015 15:01:02	

SAFE AUDIT REPORT	
Hotel Operation Example Hotel	
Room No. : 1905	Printing Time: 05-05-2015 22:09:54
TIME	OPERATION METHOD
05-05-2015 16:58:32	OPENED BY Bruce Humphrey
05-03-2015 16:58:43	OPENED BY Lorraine Lincoln
04-30-2015 16:58:54	OPENED BY John Foley
04-29-2015 16:59:13	OPENED BY KEY
04-28-2015 16:59:34	OPENED BY Tim Carl
04-23-2015 16:59:47	OPENED BY Jenny Pike
04-17-2015 17:00:01	OPENED BY Josh Lane
04-12-2015 17:00:11	OPENED BY Philip Toh
04-11-2015 17:00:25	OPENED BY KEY
04-09-2015 17:00:50	OPENED BY Bruce Humphrey
04-06-2015 17:01:06	OPENED BY KEY
04-06-2015 17:01:26	OPENED BY Jody Stansell

## 240 Event Audit Trail

Reducing fraudulent liability claims becomes even easier, saving the hotel both time and money with the 240 Event Audit Trail. If a guest claims a theft, the report will identify the last 240 opening, with openings by the MIWA key identified as "OPENED BY KEY".

### Audit retains the following:

- Time and Date of Each Safe Locking and Opening
- Full Identity (Full Name) of Authorized Staff Members Who Have Opened a Locked Safe
- Time and Date of Countdowns
- Time and Date of Medeco™ Key Openings
- Time and Date of Battery Replacement

# SAFEMARK™

The convergence of the industry's most trusted names in mobility, in-room security and electronic storage solutions.

**SAFEMARK**  
SYSTEMS

**BEST**  
LOCKERS

**ScouterBug™**  
Guest & Mobility Solutions

(800) 255 8818

(407) 299 0044

[www.safemark.com](http://www.safemark.com)